

X15

Orona



Machine-room-less electrical gearless solutions (MRLG)

High efficiency for residential and public buildings.
Optimum use of space and latest direct drive (gearless) technology.
The customised solution.
Maximum flexibility and performance.

General specifications

Load	1000 kg
Capacity	13 persons
Speed	1 - 1.6 m/s
Maximum travel	12 m
Entrances	1 front / 2 open through
Drive system	Direct gearless
Controller	ARCA III controller, low energy microprocessor
Door types	Automatic side-opening / Automatic central-opening
Clear door opening	900 to 1500mm (in 100mm increments)
Door height	2,100 / 2,100 / 2,200 / 2,300
Car dimensions Internal	Standard car dimensions
car height	2,100 / 2,200 / 2,300 / 2,400
Aesthetic solutions	Refer Orona Aesthetic Solutions

Standard Optional

Standard dimensions

Speed	Persons	Q Load	Car			Lift shaft*								
			AC Width	FC Depth	PL Clear opening	Entrances		Side-opening doors		Central-opening doors		HF Pit	HUP Last Floor	
						Accessibility	No. of entrances	AH ¹ Width	FH Depth	AH Width	FH Depth			
1 m/s	13	1,000 kg	1,100	2,100	900	Accessibility	1	2 x 180°	1,750	2,450	2,000	2,400	1,000 (830) ²	3,600 (3050) ³
			1,400	1,600	900		1		1,950	2,700		2,560		
			1,600	1,400	900		1		2,200	2,100		1,900		
1.6 m/s	13	1,000 kg	1,100	2,100	900	Accessibility	1	2 x 180°	1,750	2,450	2,000	2,400	1,250	3,750
			1,400	1,600	900		1		1,950	2,700		2,560		
			1,600	1,400	900		1		2,200	2,100		1,900		

- 1 Accessible space below the pit (counterweight with safety gear) add 50 mm to AH
- 2 HF reduced pit optional 850mm (subject to SAFEWORK SA application)

- 3 HUP minimum for internal car height (HC) of 2,100 mm (HUP = HC + 1,500)
HUP reduced headroom optional only for 6 and 8 persons (HUP = HC + 900) (subject to SAFEWORK SA application)
- * This information is not contractually binding and is subject to the conditions of the shaft

Layouts

1 ENTRANCE

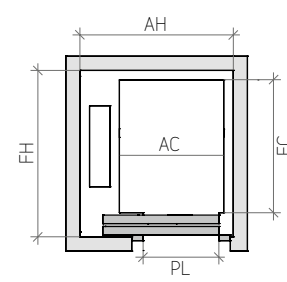

2 ENTRANCES (OPEN THROUGH)

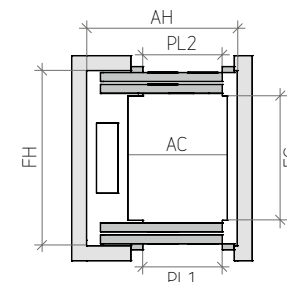

VERTICAL SECTION

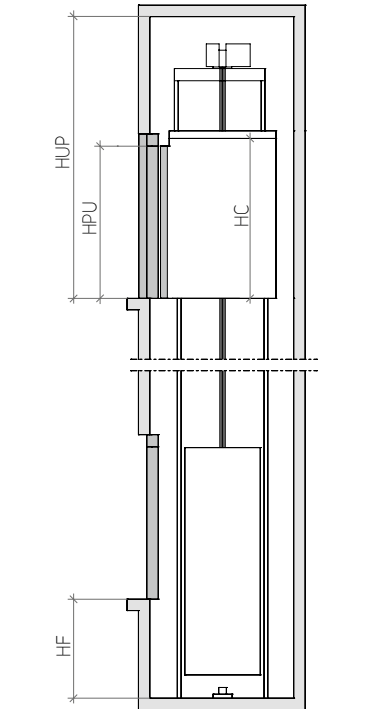

Customised car dimensions

Car depth	Car width																
	13	13	13	13	13	13	13	13	13	13	13	13	13	13	13	13	
2,100	2,000	1,900	1,800	1,700	1,600	1,500	1,400	1,300	1,200	1,100	900	1,000	1,100	1,200	1,300	1,400	1,500

Note: Car width and depth variable in increments of 5 mm.
For simplification, table samples show increments of 100 mm.

JPS Lifts

DESIGN
INSTALLATION
SERVICE
MODERNISATION

I CHOOSE SA



#ichoosesa

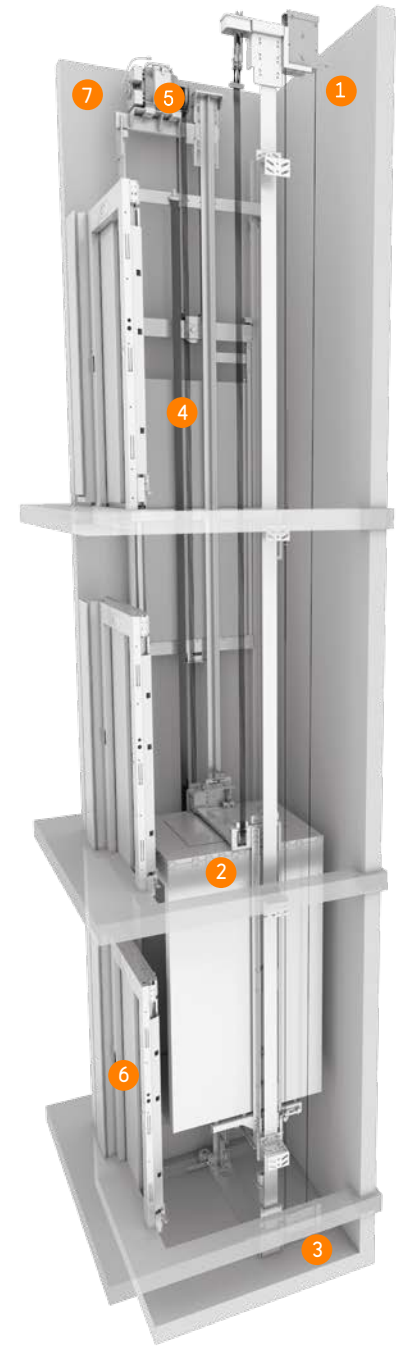

1 MRL

Compact machine-room-less solution, with optional reduced headroom version.



2 OPTIMISED PASSENGER UNIT

Saves space, reduces weight, improves safety, and improves the installation process.



3 ACCESSIBLE SPACE BELOW THE PIT

Adapts the lift to suit buildings which have an accessible space below the pit (optional).



4 TRACTION ROPES

Orona small diameter ropes replace traditional steel ropes. As a result of their lighter weight, longer lifespan and greater flexibility, it is possible to use a more compact, efficient and eco-friendly gearless machine.



5 DRIVE

Compact, quiet, gearless, energy efficient, speed regulated (VVVF) permanent magnet electric motor.



6 DOORS

Compact permanent magnet motor for fast, accurate and quiet door operation giving the most advanced performance. Advanced door opening and full height infra red door protection edges. Optional Solid Door for high flow situations.



7 AUTOMATIC RESCUE SYSTEM

With floor level indication to ensure fast, efficient and safe evacuation of passengers in the event of an emergency. As an option, the system can incorporate a fully-automatic rescue device to evacuate passengers in the event of a power failure.

